

OmniSuit Washing Guide

AUXIVO

AUXIVO

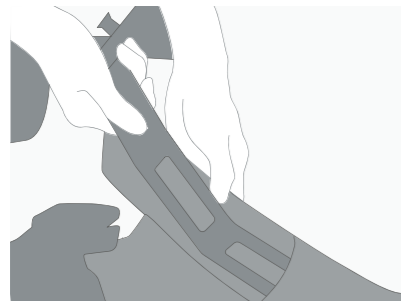

Separate the textiles, rigid parts and back elastics prior to washing.

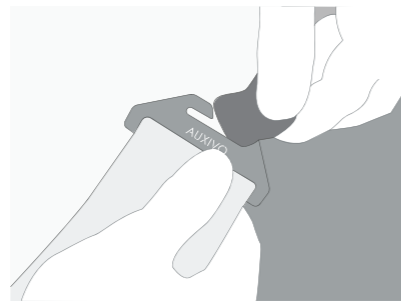

First, remove the back EES by pulling the textile band to one side of the metal hook.



When the textile band slips out of the hook, pull it out. Repeat the process for the other connection.

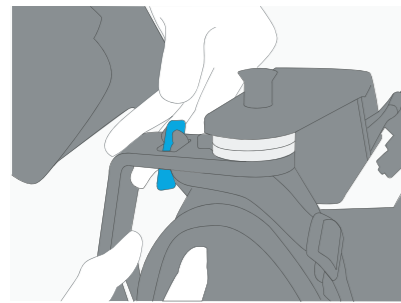

Tilt and push the attachment buckle through the slot in the back structure.

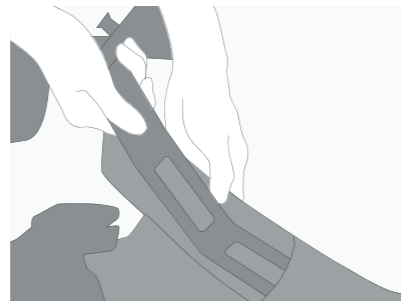

Pull the back structure out of the vest pocket.

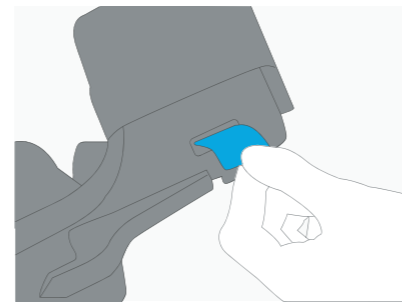

Detach the Velcro strap on the bottom of the arm cuff, to loosen the arm cuff textile cover.

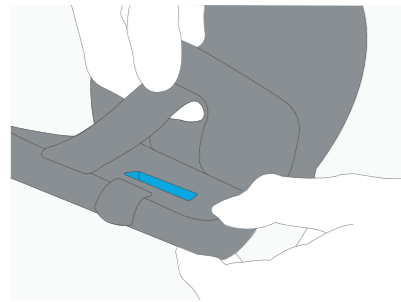

Pull the arm cuff textile cover off the arm cuff.



Wipe all non-textile parts with a damp cloth and air dry.



Close the release buckles and Velcro straps and place the textile parts in a washing bag.



Machine wash the textiles at 30°C. Do not use fabric softener. Use mild detergent. Wash separately. Only gentle spinning.

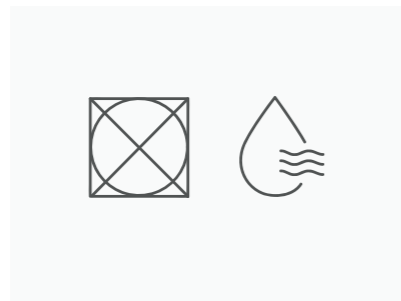

Air dry the textile components. Make sure that it is fully dried before using it.



Reassemble the textile and rigid components (see back) and perform a visual check according to the user manual.

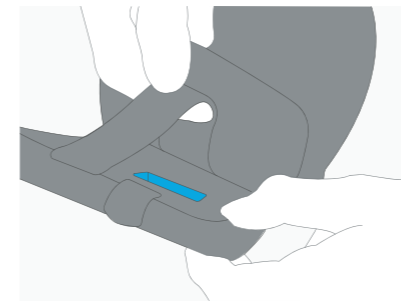

Attach arm cuff textile cover on each arm cuff, and close using velcro strap.

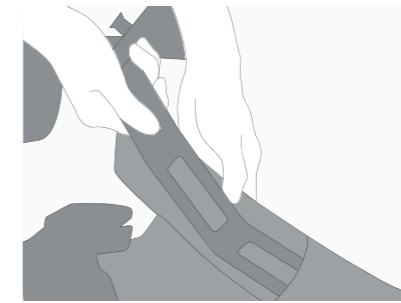

Insert the back structures into their vest pocket.

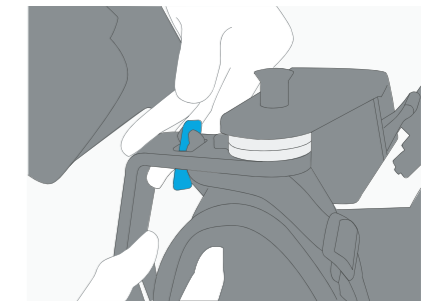

Attach each shoulder attachment buckle to the slot on each back structure.

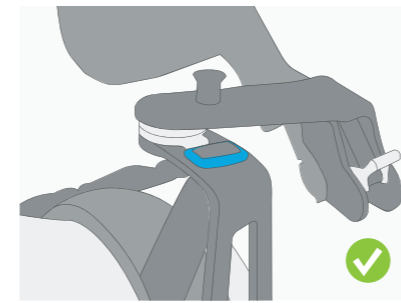

Check that the connection buckle at the shoulder is attached.

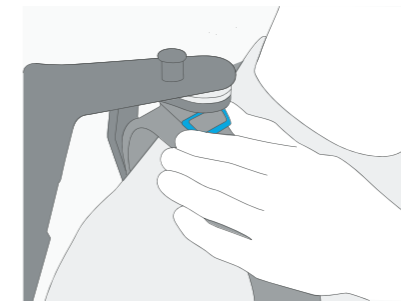

Move the buckle at the shoulder upwards to increase the stability of the attachment between shoulder structure and vest.

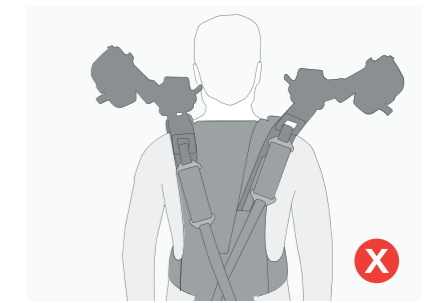

Make sure there is no empty space at the bottom of the vest pocket, and the OmniSuit looks symmetrical.



Start by inserting the longer side of the EES hook into the loop of the upper connecting strap.

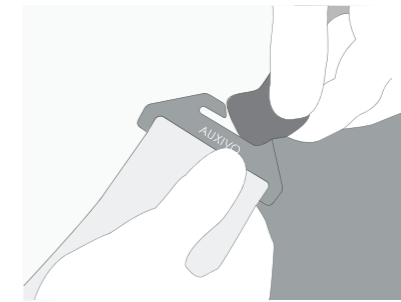

Then squeeze the loop onto the shorter side of the hook. Repeat the process for the lower connection and the other side.

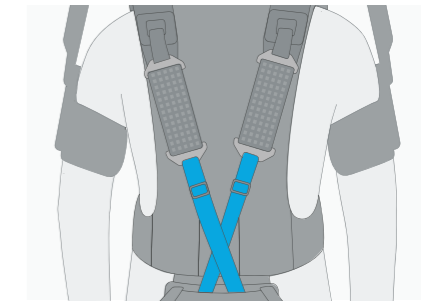

Take the strap from the opposite thigh cuff, so that the straps cross at the user's lower back.

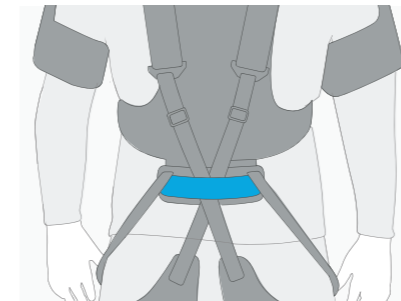

Make sure the connecting strap run through the tunnel in the hip belt.

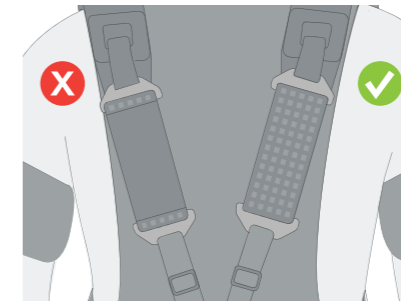

Make sure the black-white patterned side of the elastics are facing you.



After performing a visual check the OmniSuit is again ready to support you during work.